

Report on the Monuments of Northern

Nepal

(continued)

-Corneille Jest

Monuments of Kabre District

Temples of Timal Dhara

In the zone located between the Indrawati Sun Kosi and Rosi Khola rivers are located the following temples :

Lamagaon
Dharagaon
Dorjegang
Kalleri
Parsel
Pokari
Dharagaon
Tsoptar
Palugar

These temples are all located in rich cultivated land at an altitude of 1000 m.

The buildings are of very simple form with a pitched roof.

An entrance porch gives access centrally through a double leaved door into the chapel. The chapel rectangular in shape follows the plan of four pillars supporting the roof, with the altar opposite the entrance door.

The walls are decorated with paintings.

The yearly festivals occur in the month of

Bhadau (Aug.-Sept). The whole community meets on that occasion for one day ; the festival ends with a religious dance.

The temple is used only on 1 or 2 occasions in one year, during the festival, and at the end of the period of religious instruction.

Temple of Bantali

The temple of Bantali is located in the middle of a Tamang settlement on a southern slope at an altitude of 1800 m.

The temple, set in a courtyard, is built on a small platform (h : 0,40 m).

The building is a two storey construction (exter. dim. : 5,50 m x 7,55 m - H. of the temple: 2,60 m - H. of the first floor : 1,80 m).

The facade of the temple is open to the South.

The walls are in stones, the roof is pitched, covered with slates and has an additional small roof of Gumaune type.

A door gives access to the chapel (dim. : 4,40 m x 6,60 m).

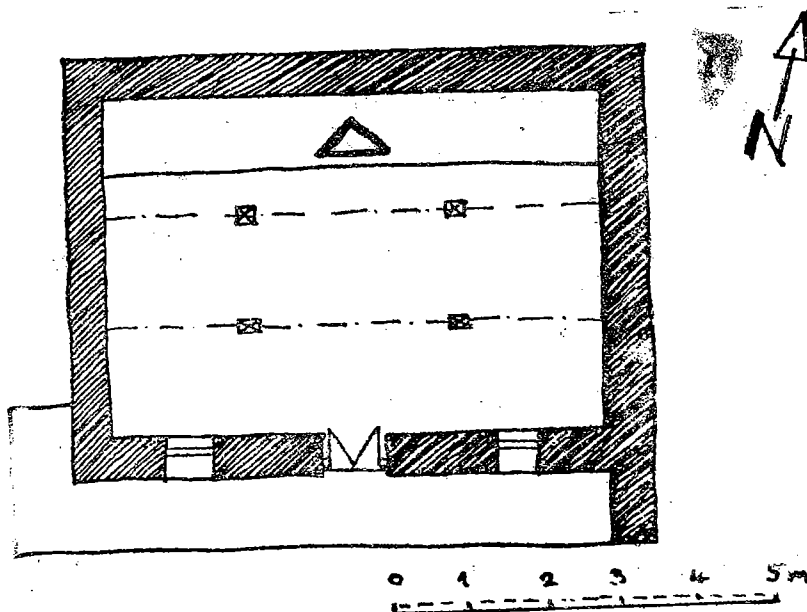

Kabre district; temple of Bantali temple; extern. dim.: 7,75x 5,50 m.
Chapel: 4,40 x 6,50 m.

Four pillars support the ceiling.

On the altar (H : 1,00 m) clay images (from left to right) of Guru Dragpo, Chenresi, Dorjechang, Sakyamuni, Sangye Chomden, Mindrugpa, Guru Rinpoche, Senge Dngmo.

Present condition

The northern and western walls are in bad condition due to water infiltration and the 1980 earthquake.

The roof very badly laid (lack of material and beams) leaks.

The temple is damp ; dampness coming from the soil and absence of drainage during the rainy period, water circulates on the northern side which is slightly at a higher level, the temple being built on a slope.

Religious books

Domang, Midrugp Konchog Chudi,

Guru Gongsal, Bardo Todol, Shitro Mani- (Dochenpa) Dorje Sempa, Sol Deb, Drolma Kurim, Monlam.

On the southern side hangs a bronze bell with an inscription and date : 1982 B.S.

The lama-in charge is Nyima Tsering Bal, of the sect Drugpa Mindrugpa.

There are 22 monks attending the ceremonies.

Main ceremonies

Full moon of Saun

Full moon of Magh (Feb. : New Year).

The temple of Bantali is important in the history of this part of Central Nepal and quoted in donations in connexion with other shrines such as Puri.

The present temple was built in 1969 replacing an older construction which was threatened by a land slide.

Temple of Majhipetha, Gyang Tol

Wangdrup Gyang

The temple is built on the edge of a ridge at an altitude of 1440 m and is surrounded by Ficus trees.

The building stands on a platform and is of rectangular size (5,00 m x 8,70 m).

The walls are in stone bedded in mortar.

The two sloped roof is covered with tiles of the Newari type.

The chapel (4,00 m x 7,50 m): two pillars support the roof. On the altar clay images of Guru Dragpo, Jampala, Sakyamuni, Dorjchang, Chenresi, Guru Rinpoche.

The walls are painted on three sides.

Present condition

The roof is in a bad condition and needs repair.

Books

Domang. A number of books have been

destroyed by negligence. The lama has a book of the genealogy of the clan in his possession.

The Head Lama, Nawal Singh Yondzan, is also a member of the National Panchayat, member of the Nyingmapa sect.

The temple belongs to the lineage.

Temple of Nagre / Tsalaku Gyang

Tamakhani Panchayat

The temple is a two storeyed building, on rectangular plan, of the standard style (see Puri Gyang).

It was rebuilt in 2018 B.S. (1961 A.D.).

It contains images of Guru Rinpoche, Opame, Maning, Guru Dragpo, Senge Dagma.

A Lalmohar of 1936 B.S. (1879 A.D.) quotes the temples of Puri, Bangtali, Nagre, Lisankhu, Rishangko, Charikot, Phalasi.

A private Guthi (Niji Guthi) is attached to the temple.

(To be continued)

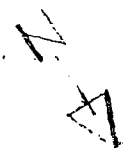
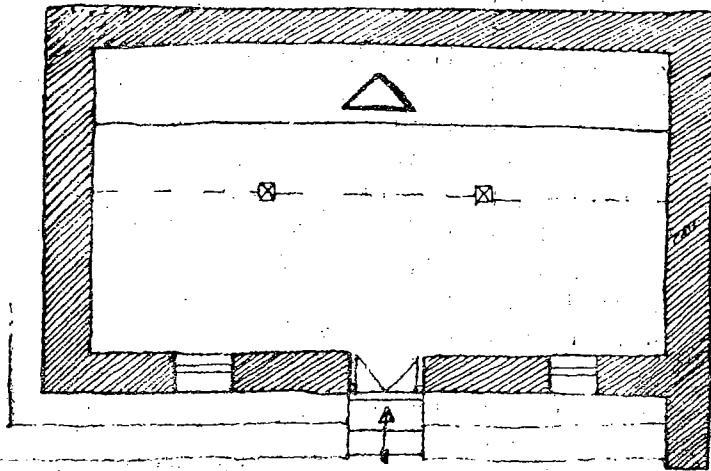

0 1 2 3 4 5 m

Kabre district; temple of Bantali: temple extern. dim.: 5,00 x 8,70 m.

Chapel: 4,00 x 7,50 m.